

# Architectural Millwork Hub - Trim Option 1 - Finish Details

# 1

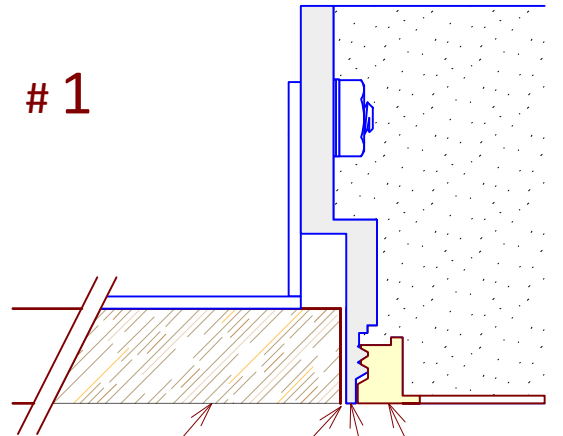

surface of millwork  
3/8 - 1 inch thick

reveal

front edge of hub  
aligned with millwork

cover

the millwork surface, hub and cover  
are flush and aligned

the hub can be adjusted for other finish  
options after installation

if edge of hole does not cut clean or requires patching filling or  
repair, the hub provides a support surface and true edge to  
align the repair

the front edge of the hub is usually provided in black matching  
the reveal shadow and may be field finished as needed

Ø 2.125"  
mounting hole cutout

Ø 2.07"  
front edge of hub  
field paintable  
specify finish

BL - black anodized aluminum  
CL - clear anodized aluminum

Ø 1.95" cover

field paintable  
specify finish

WT - white painted aluminum  
CL - clear anodized aluminum

reveal

